

Moving your e-TAG in and out of the holder

We recommend that you remove your e-TAG only to move it to another vehicle of the same class.

1. Hold the e-TAG firmly with one hand.

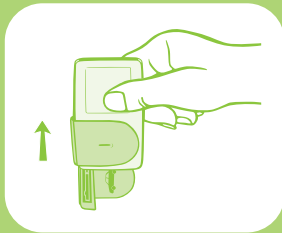

2. Slide the e-TAG up to remove from the holder.

3. To replace your e-TAG in the holder firmly slide it down until you hear a 'click'.

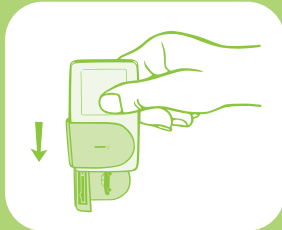

It's important to install your e-TAG

If your e-TAG isn't installed according to the directions provided in this guide it may not work and you risk receiving a Toll Notice, which may include an extra administration fee.

Don't forget, you can order extra e-TAG holders and swap your e-TAG between vehicles of the same class as long as you've advised us of the vehicle details.

Contacting Roam Express



help@roamexpress.com.au
roamexpress.com.au



13 ROAM (13 76 26), Fax 02 9869 4519



Locked Bag 2215, North Ryde BC, NSW 1670



Customer Care Centre, M2 Administration Building,
Tollaust Lane, off Culloden Road, North Ryde NSW

Frequently Asked Questions

Q: On which motorways will my Roam Express e-TAG work?

A: Your e-TAG is accepted on all toll roads in Sydney, Melbourne and Brisbane.

Q: What sound should my Roam Express e-TAG make?

A: A beep indicates a successful transaction. If the e-TAG makes any other sound or no sound at all contact Roam Express as soon as possible as there may be a problem with your e-TAG or your account.

Q: Do I have a Class 2 (light) or Class 4 (heavy) vehicle?

A: A Class 2 vehicle has 2 axles and is not over 2.8m in height, or 3 axles and is not over 2m in height. All other vehicles are Class 4. Most cars, light trucks, cars with low trailers and motorcycles are Class 2 vehicles. Most trucks and buses are Class 4 vehicles.

Q: Is the Roam Express e-TAG interchangeable between vehicles?

A: Yes, between vehicles of the same class, provided the e-TAG is mounted as per instructions. Additional e-TAG holders are available from the Roam Express Customer Care Centre or can be requested over the telephone.

Q: Can I use a Roam Express e-TAG on a motorcycle?

A: The e-TAG that is provided with this guide is not suitable for a motorcycle. Please ask our Customer Care Centre for advice on a suitable e-TAG and the special mounting instructions required for a motorcycle.

Q: When should I change my Roam Express e-TAG batteries?

A: The batteries are designed to last for 5 years of normal use. When your batteries need changing we will contact you.

Q: Which type of holder do I need?

A: Most cars and light vehicles have an angled windscreen and most heavy vehicles have a vertical windscreen. However some cars (eg. vintage cars) may have a vertical windscreen. Please let us know if you think you need a different holder, or need help deciding which holder is right for your vehicle.

INSTALL_ETAG_RE 09/08

Roam Express Made easy

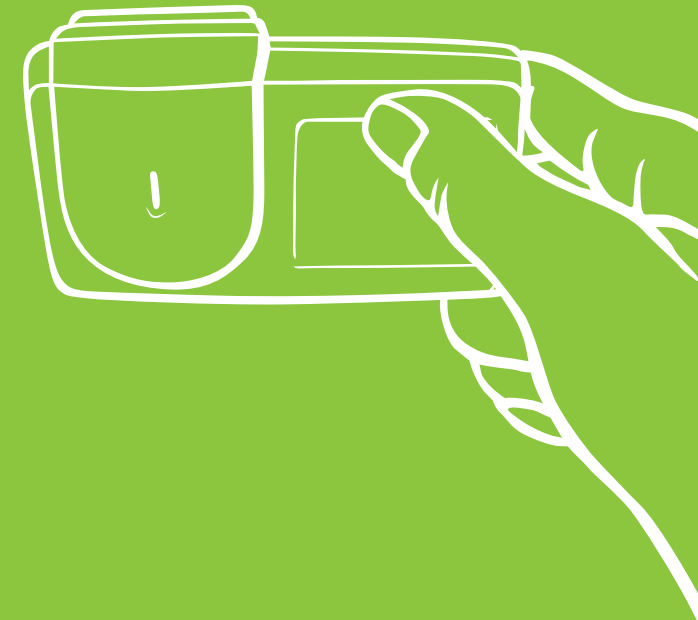

e-TAG Installation Guide

Roam.
EXPRESS

transurban

Roam Express e-TAG®s

This guide provides instructions on how to install your e-TAG. There are two types of e-TAGs: one for cars and light vehicles and one for heavy vehicles. Following are instructions on how to identify your e-TAG. If you require any assistance to do this, or if you wish to install your e-TAG on a motorcycle, please call Roam Express on 13 ROAM (13 76 26).

e-TAGs FOR CARS AND LIGHT VEHICLES

(Class '2')

Your e-TAG for cars and light vehicles will have a car icon on the holder and the e-TAG number under the barcode will start with the numbers '02'.

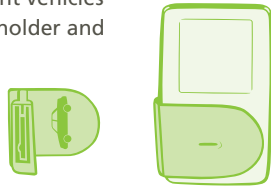

e-TAGs FOR HEAVY VEHICLES

(Class '4')

Your e-TAG for heavy vehicles will have a truck icon on the holder and the e-TAG number under the barcode will start with the numbers '04'.

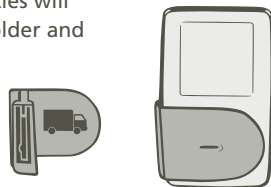

If you require any assistance, please call Roam Express on 13 ROAM (13 76 26).

* Please note: If your vehicle has a metallic windscreen, check the manual (or contact the manufacturer or distributor) for the correct position on the windscreen to install your e-TAG. If you don't install the e-TAG in the correct position and it does not beep you may be charged an administration fee per trip.

© e-TAG is a registered trade mark. Roam Express is a trade mark.

Installation guide for cars and light vehicles

Installing your e-TAG on your windscreen

Please ensure that you install your e-TAG correctly.

1. Insert your e-TAG into the holder. Trial fit the e-TAG and the holder without removing the adhesive backing*.



You can install your e-TAG on your windscreen either vertically or horizontally.

As shown, place the e-TAG behind the rear view mirror, making sure it will fit there and not obstruct the driver's vision.

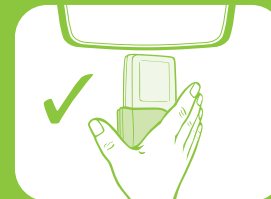

Make sure that you leave enough room around your e-TAG to be able to slide it from its holder once mounted. You also need to make sure that there is at least 7 cm clearance between the e-TAG and any objects such as sun visors.



2. When you are happy that you have identified an appropriate position on your windscreen, use the enclosed cleaning wipe to clean the windscreen where the holder will be placed. Please ensure the surface is dry before attaching the holder.



3. Peel the adhesive backing from the holder.

4. Making sure that the holder is straight and that the adhesive surface of the e-TAG faces outwards, carefully position the e-TAG and the holder, and hold firmly for one minute. Do not attempt to remove the e-TAG from the holder for at least 24 hours.

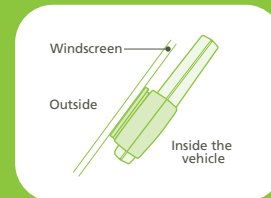

5. When correctly installed, the adhesive surface of the holder will face outwards.

Installation guide for heavy vehicles

Installing your e-TAG on your windscreen

Please ensure that you install your e-TAG correctly.

1. Insert your e-TAG into the holder. Trial fit the e-TAG and the holder vertically on your windscreen without removing the adhesive backing*.

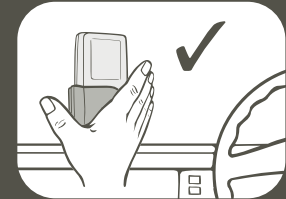

As shown, place the e-TAG in the centre of your windscreen a few centimetres above the dashboard.

Make sure your e-TAG is straight and doesn't block your vision. You also need to make sure that there is at least 7cm clearance between the e-TAG and any objects.

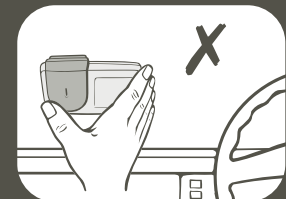

2. When you are happy that you have identified an appropriate position on your windscreen, use the enclosed cleaning wipe to clean the windscreen where the holder will be placed. Please ensure the surface is dry before attaching the holder.

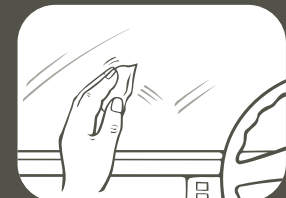

3. Peel the adhesive backing from the holder.

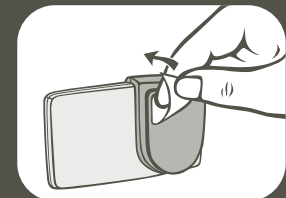

4. Making sure that the holder is straight and that the adhesive surface of the e-TAG faces outwards, carefully position the e-TAG and the holder, and hold firmly for one minute. Do not attempt to remove the e-TAG from the holder for at least 24 hours.

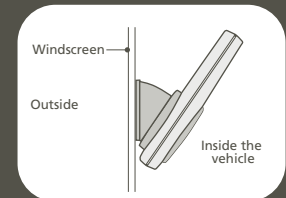

5. When correctly installed, the adhesive surface of the holder will face outwards.